



CAPITAL TOOL INDUSTRIES

Code
Desig. Num.

EXTERNAL GEAR'S SPECIFICATION

PART NUM.	
TOOTH PROFILE	
OPERATION	
MODULE / D.P.	Mn
PRESSURE ANGLE	α
NUM. OF TEETH	z1
HELIX ANGLE	β
OUTSIDE DIAMETER	dk1
PITCH DIAMETER	d _{o1}
ROOT DIAMETER	df1
WHOLE DEPTH. (D+f)	h
ADDENDUM MODIF.	xma
TOOTH THICKNESS	Sn
OVER PINS Ø FINISHING	Mr
OVER PINS Ø SHAPED	Mr'
PIN DIAMETER	dr
SPAN MEASUREMENT F	Wn
SPAN MEASUREMENT H.	Wn'
NUM. OF TEETH SPANNED	zn
STOCK PER FLANK	
CHAMFER DIA.	
TIP MODIFICATION	
ACTIVE DIAMETER	d _{uf}
SAP (Start active profile)	

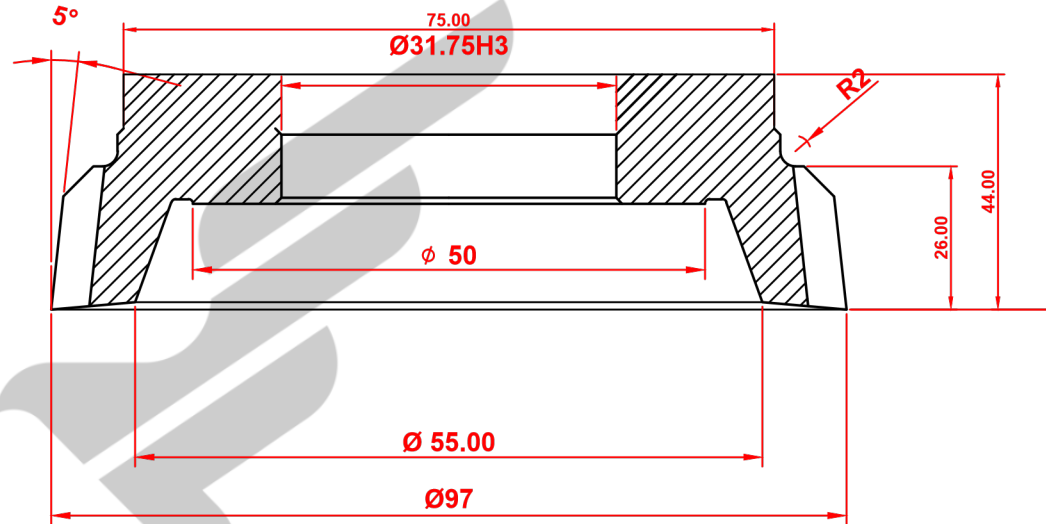

D+F =
Modif = 0

SHAPER SPECIFICATION

SIDE CLEARANCE R. FLANK	2.5°
SIDE CLEARANCE L. FLANK	2.5°
PCD	95
NUM. OF TEETH	i 50
HELIX ANGLE	β 0°LH
MODULE / D.P.	Mn 1.9
PRESSURE ANGLE	α 30°NPA
CLASS	A DIN 3968
KEYWAY	NO
MATERIAL OF SHAPER	ASP30 + TIN
SHAPER SIZE	
RAKE ANGLE	ϵ
CAM	hr
CLEARANCE ANGLE	φ_K / φ

MARKING:
ASP30 HUB TYPE SHAPER 1.9 MOD 50-T 0°HA
30°NPA CL-A FIN NT DIN 5482

DESIGN	APPROVED
DATE :	DATE :
CHARGE: CAPITAL	APPROVED:

Własność intelektualna firmy:
Tradensa Sp. z o. o.
Ul. Urocza 5a, 62-081 Wysogotowo
NIP: 781-20-22-828
KRS: 0000910290

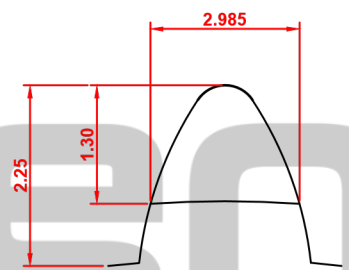

BASIC TOOTH OF CUTTER

ALL UNITS ARE IN MILLIMETERS



Customer	158	A	DESIGN EDITION	CAPITAL	24 - 10 - 17

DISC SPLINE SHAPER CUTTER