



CAPITAL TOOL INDUSTRIES

Code
Desig. Num.

EXTERNAL GEAR'S SPECIFICATION	
PART NUM.	
TOOTH PROFILE	
OPERATION	
MOD	Mn 8
PRESSURE ANGLE	$\alpha$ 20°
NUM. OF TEETH	z1 68
HELIX ANGLE	$\beta$
OUTSIDE DIAMETER	dk1 568.798
PITCH DIAMETER	do1 544.0
ROOT DIAMETER	df1 534.15
WHOLE DEPTH. (D+f)	h
ADDENDUM MODIF.	xm
TOOTH THICKNESS	Sn
OVER PIN Ø FINSHING	Mr
DOP	Mr' 526.065
PIN DIA	dr 15
SPAN MEASUREMENT F	Wn
SPAN MEAS H. OVER 3 T	Wn'
NUM. OF TEETH SPANNED	zn
FINISHING STOCK FLANC	Cn
START OF CHAMFER DIA	PLEASE CONFIRM
ROOT FORM DIA	
ACTIVE DIAMETER	duf
SAP (Start active profile)	

SHAPER SPECIFICATION	
SIDE CLEARANCE R. FLANK	2.5°
SIDE CLEARANCE L. FLANK	2.5°
PITCH DIAMETER	do1 144
NUM. OF TEETH	i 18
HELIX ANGLE	$\beta$ 0°
MOD	Mn 8
PRESSURE ANGLE	$\alpha$ 20°
CLASS	A
ADDENDUM MODIF.	
MATERIAL OF SHAPER	S590 ALCRONA
SHAPER SIZE	
RAKE ANGLE	$\epsilon$
SPAN MEAS. OVER 2 TEETH	WK
CLEARANCE ANGLE	$\varphi_K / \varphi$
MARKING:	8 MOD 20°PA CL-A 18-T SEMITOPPING ALCRONA FOR-68 NT FIN S590
DESIGN	APPROVED
DATE :	DATE :
CHARGE:	APPROVED:

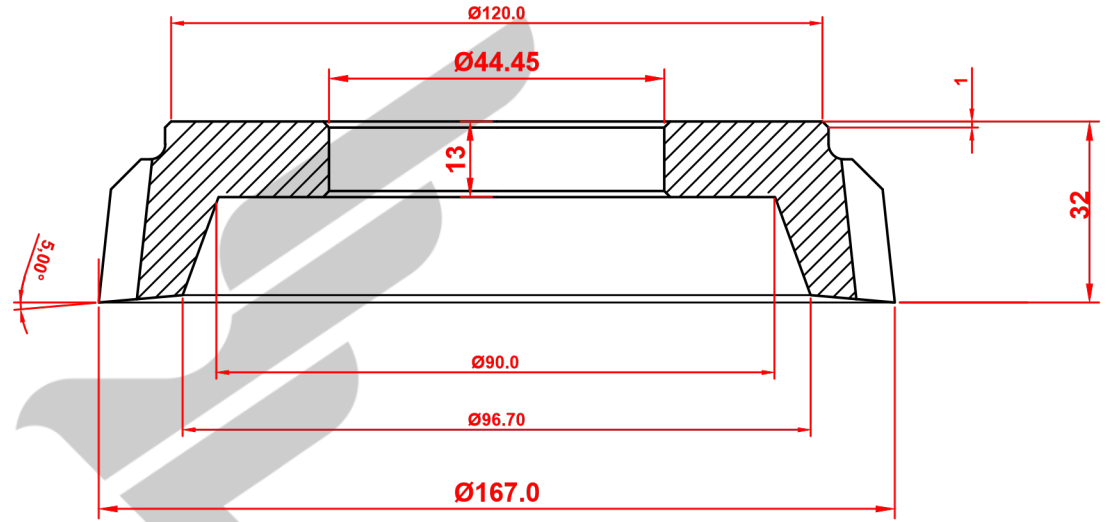

D+F =  
Modif = 0

**Własność intelektualna firmy:**  
**Tradensa Sp. z o. o.**  
 Ul. Urocza 5a, 62-081 Wysogotowo  
 NIP: 781-20-22-828  
 KRS: 0000910290

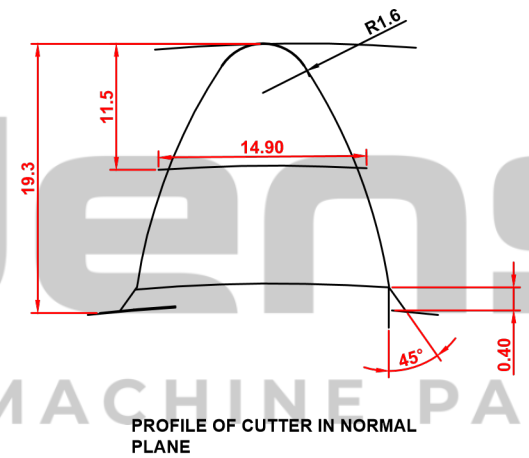

PROFILE OF CUTTER IN NORMAL PLANE

**HUB SHAPER CUTTER**

ALL UNITS ARE IN MILLIMETERS

Customer	C5.115/352	A	DESIGN EDITION